



Northwood PARK

*A distinctive new
neighborhood in
Brush Prairie, WA*



63'

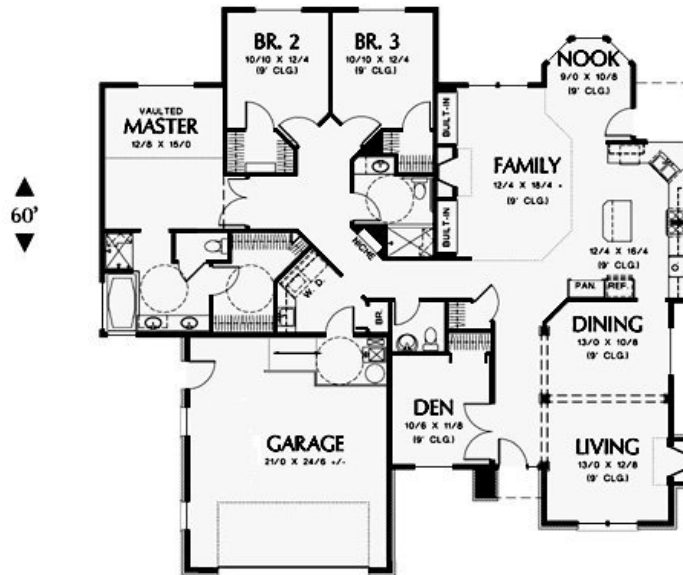

RMLS # 6003279

Lot # 49

Builder: Dream Builk

Total Sq Ft: 2800

Price: \$490,500

www.northwoodpark.com

*Visit the web for info on lots, plans, builders and availability
Ask us about custom plans for your Dream Home!*

This spacious ranch home has been designed for handicap access . This Universal Design home has wide hallways and doors, with no stairs to impede strength or mobility impaired family members. Bathrooms are designed so a wheelchair can turn around. There are grab bars beside the toilets and benches in the showers. This three bedroom plan has a spacious family room and a living/dining room combo. Double doors lead to the den off the entry. Dream Builders II standard features include Granite in the kitchen w/ stainless steel appliances, hardwood flooring, 9 ft. ceilings, landscaped fronts with sprinklers and lots more!

Marketed by:



John Morris
360-600-6689



Loren Lester
360-798-0639



BARBARA SUE SEAL
PROPERTIES